

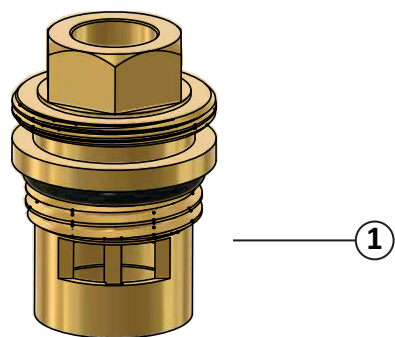

**Venus Precision**

Web. : [www.venusprecision.com](http://www.venusprecision.com)



1 Brass Body

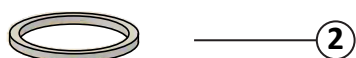

2 Lubricating Stem Washer

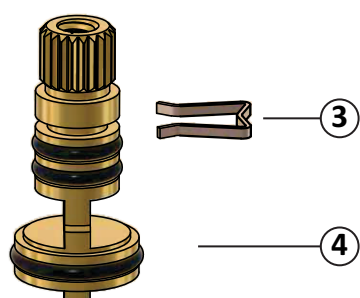

3 Lock

4 Stem

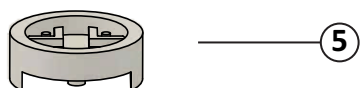

5 Ceramic Disc Holder



6 Ceramic Moving Disc

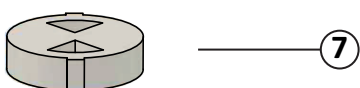

7 Ceramic Fixed Disc

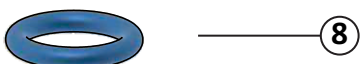

8 O-ring

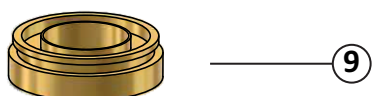

9 Base

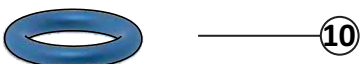

10 O-ring Washer

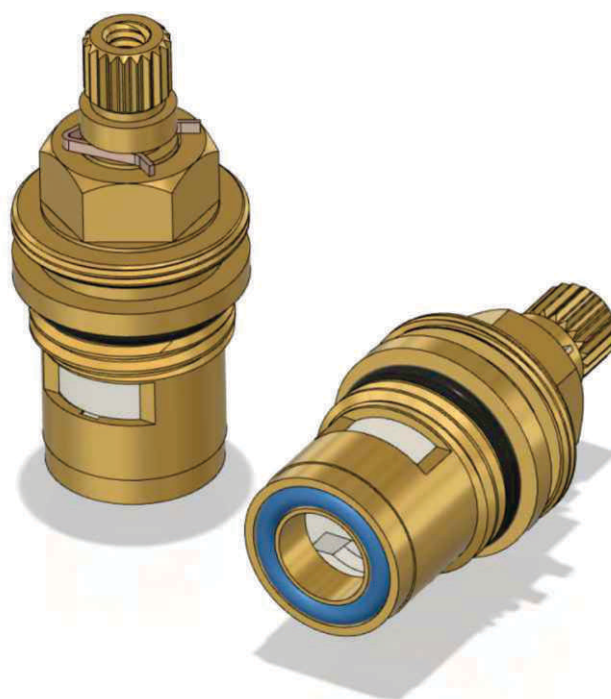

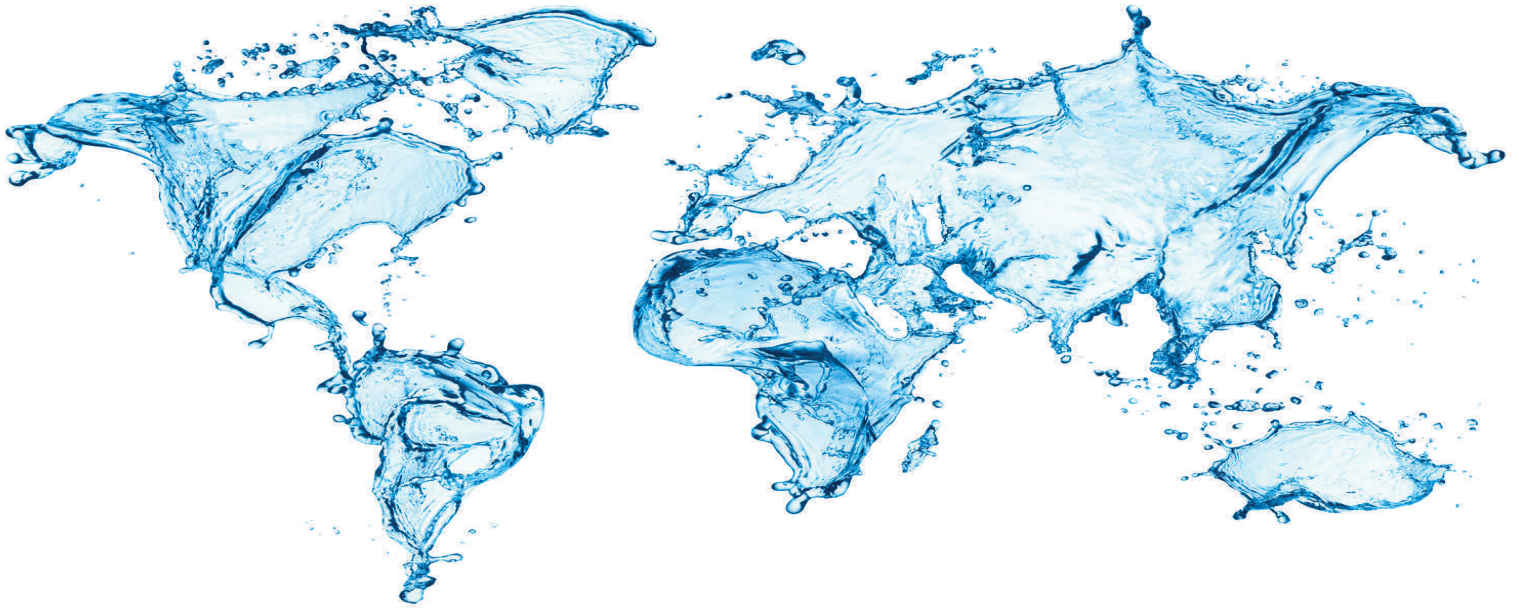

## Company Profile

Venus Precision Respected Throughout The Indian As One Of The Leading Manufacturers Of Brass And Plastic Ceramic Cartridges, The Company Is Known For Its Service, Flexibility, High Quality Standards And Most Competitive Prices. Venus Precision Is Specialist For All Types Of Brass Cartridge, Plastic Ceramic Cartridge, Precision Brass Parts And Sanitary Fittings Requirements Both Standard And Customer Design.

Our Products Include Full Range Of Brass Cartridge, Plastic Diverter Cartridges , Single Lever Plastic Cartridges Precision Plastic Parts And Sanitary Fittings.

In Order To Acquaint You With Our Business Lines Please Load Our Website [Www.Venusprecision.Com](http://www.venusprecision.com)

Venus Precision Also Offers High Quality Brass Turned Components, Precision Brass Parts And Sanitary Fittings Parts That Meet The Specific Requirements Of The Industry.

Supported By Means Of Long Term Experience And Technology Of Global Standards And Motivated By A Committed Band Of Professionals, We Have Always Endeavored To Achieve Customers' Satisfaction By Delivering Products And Services, Which Are Reliable And Are Of High Quality As Per The Specified Requirement. Strict Quality Checks Are Conducted And Recorded At Various Stages Of Production Right From The Procurement Of Raw Material Till The Dispatch Of The Finished Products. We Ensure To Produce High Precision Components That Meet All Performance Requirements And Highest Quality Standards.

With Our Skilled Quality Control Department, Which Ensures That Each Product Manufactured As Exactly To The Print And Each Process Are Controlled And The Quality Of The Parts Maintained Throughout The Entire Process. We Provide Inspection Reports To Our Customers If Required.







**EVERY  
DROP  
COUNTS**

## TOP 5 WAYS TO SAVE WATER IN YOUR HOME



Take a shower of 5 minutes or less

Saves up to  
70 Litres  
per shower



Install a water-saving toilet flush system

Saves up to  
700 Litres  
each year



Turn off the tap while brushing your teeth and washing your hands

Saves up to  
20 Litres  
per day



Don't keep the tap running while washing clothes/utensils

Saves more than  
50 Litres  
per day



Close taps properly and fix leaking taps, pipes and toilets

Saves up to  
75 Litres  
each day

**FACTS  
---- AND ----  
FIGURES**

**76 million people**  
in India do not have access to  
safe drinking water



**54% of India faces**  
high to extremely high water stress





# INDEX.....

## 1/2" Quarter Turn Brass Cartridge

VP40A	01
VP45A	02
VP55A	03
VPG58KA	04
VPG50A1	05
VPGI54A	06
VP85CA	07
VPG85CA	08

## 22M x 1.5 Quarter Turn Brass Cartridge

VP2265A	09
---------	----

## 3/4" Quarter Turn Brass Cartridge

VP3482A	10
VP34G85A	11
VP34CA	12

## 1/2" Quarter Turn Plastic Cartridge

VP2PB	13
VP1PB	14
VP1P	15

## Diverter Ceramic Cartridge

VP22DA	16
VP25DA	17
VP25DC	18
VP31DA	19

## Flush Valve Cartridge / Diverter Cartridge

VP1FVC / VPT22D27	20
-------------------	----

## Other Cartridge

Engineering Plastic Parts	22
---------------------------	----

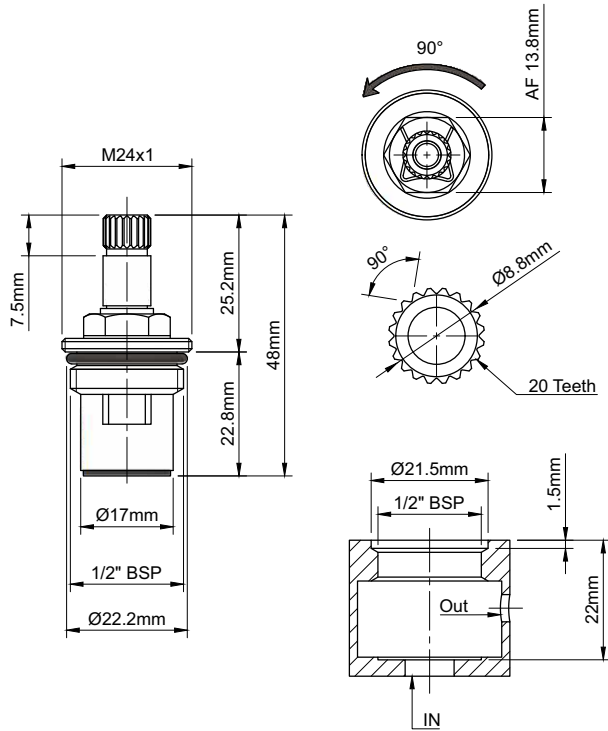

Recommended Dimension For Faucet Body



### Technical Data

Max. Rotation Angle	90°
Connection Thread	1/2" BSP - G 1/2"
Working Temperature	3-90° C
Fuction	QUICK OPEN FAUCET

### Water Flow Rate Test

Pressure (Bar)	0.5	1.0	1.5	2.0	2.5	3.0	3.5	4.0
Flow Rate (L/min)	7.1	8.8	11.0	12.2	14.0	16.0	17.1	18.2

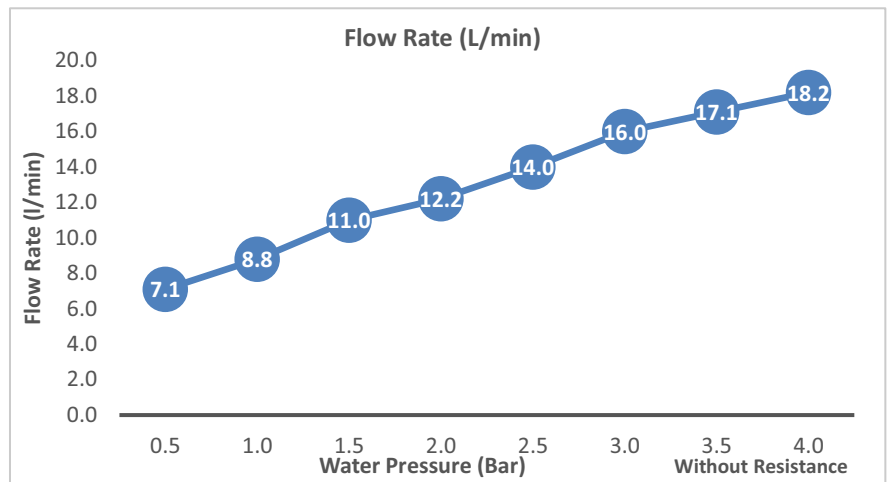

### Technical Data Of The Ceramic Disc

Material	97% AL <sub>2</sub> O <sub>3</sub>
Surface Roughness	Ra≤0.25µm
Flatness	≤0.6 µm
Surface Contact rate	50%-80%
Hardness	1050HV5

### Material Specification

Body Material	IS 319-I
Stem Material	IS 319-I
O'RING	NBR
Washer	Sillicon
Lubricating Ring	MOS-2
Lock	Copper

Sealing Test	Static Pressure	Air	High pressure	8 bar
		Water	Low pressure	0.2 bar
	Dynamic Pressure		High pressure	25 bar
		Low pressure	0.5 bar	
Life Test	> 250000 cycles ( Meet The EN 200 Request )			
The Brusting Test	35 bar Water Static Pressure *No Deformation Found on the Cartridge.			

We perform 100 % High Air Pressure Testing on Each Cartridge Befor Dispatch

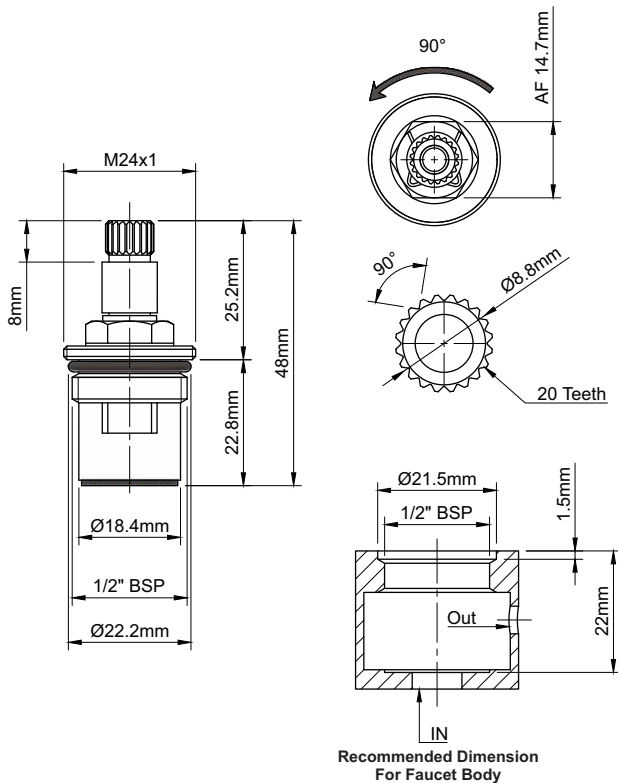

### Technical Data

Max. Rotation Angle	90°
Connection Thread	1/2" BSP - G 1/2"
Working Temperature	3-90° C
Fuction	QUICK OPEN FAUCET

### Water Flow Rate Test

Pressure (Bar)	0.5	1.0	1.5	2.0	2.5	3.0	3.5	4.0
Flow Rate (L/min)	7.6	11.2	14.3	16.8	18.8	20.8	22.3	23.9

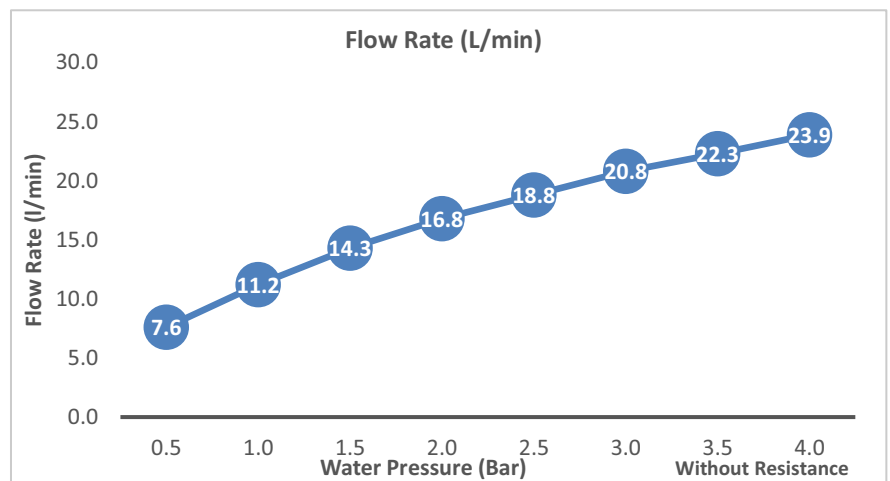

### Technical Data Of The Ceramic Disc

Material	97% AL <sub>2</sub> O <sub>3</sub>
Surface Roughness	Ra≤0.25µm
Flatness	≤0.6 µm
Surface Contact rate	50%-80%
Hardness	1050HV5

### Material Specification

Body Material	IS 319-I
Stem Material	IS 319-I
O'RING	NBR
Washer	Silicon
Lubricating Ring	MOS-2
Lock	Copper

Sealing Test	Static Pressure	Air	High pressure	8 bar
		Water	Low pressure	0.2 bar
	Dynamic Pressure	Water	High pressure	25 bar
		Water	Low pressure	0.5 bar
Life Test	> 250000 cycles ( Meet The EN 200 Request )			
The Brusting Test	35 bar Water Static Pressure *No Deformation Found on the Cartridge.			

We perform 100 % High Air Pressure Testing on Each Cartridge Befor Dispatch



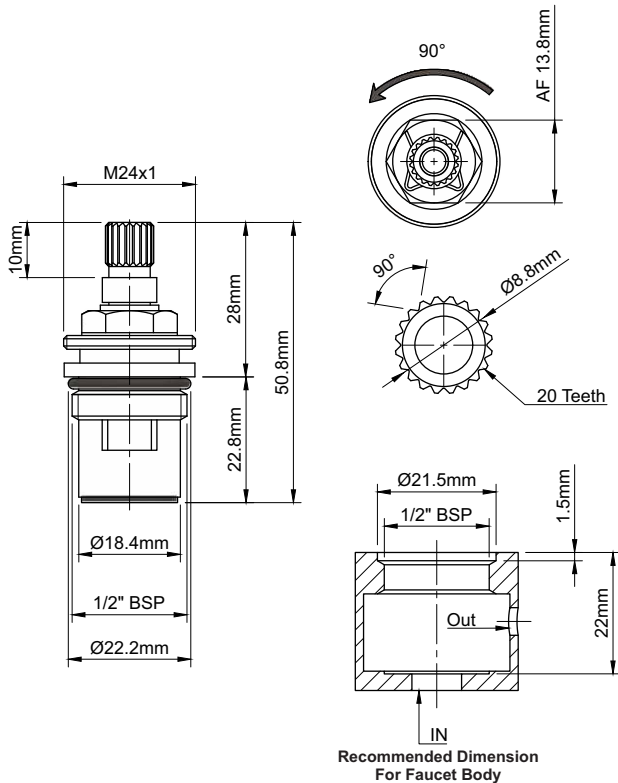

### Technical Data

Max. Rotation Angle	90°
Connection Thread	1/2" BSP - G 1/2"
Working Temperature	3-90° C
Fuction	QUICK OPEN FAUCET

### Water Flow Rate Test

Pressure (Bar)	0.5	1.0	1.5	2.0	2.5	3.0	3.5	4.0
Flow Rate (L/min)	7.9	11.7	14.7	17.2	19.5	21.4	23.3	24.8

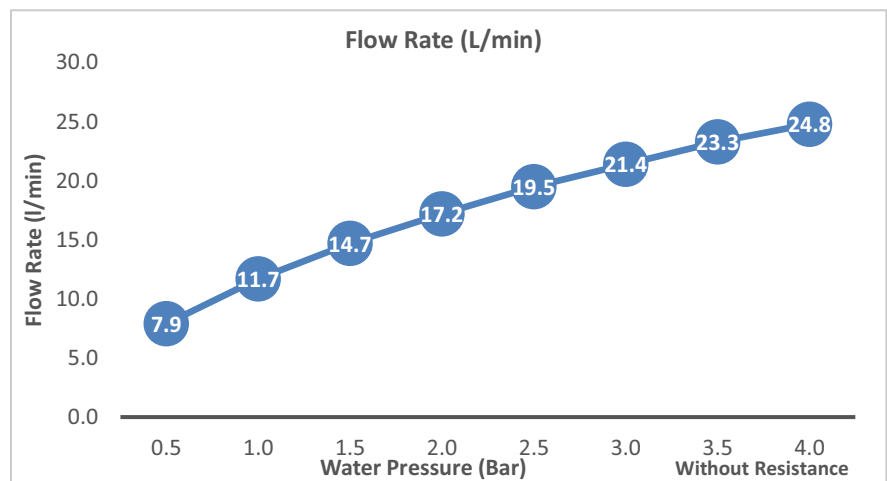

### Technical Data Of The Ceramic Disc

Material	97% AL <sub>2</sub> O <sub>3</sub>
Surface Roughness	Ra≤0.25µm
Flatness	≤0.6 µm
Surface Contact rate	50%-80%
Hardness	1050HV5

### Material Specification

Body Material	IS 319-I
Stem Material	IS 319-I
O'RING	NBR
Washer	Sillicon
Lubricating Ring	MOS-2
Lock	Copper

Sealing Test	Static Pressure	Air	High pressure	8 bar
		Water	Low pressure	0.2 bar
	Dynamic Pressure	Water	High pressure	25 bar
		Air	Low pressure	0.5 bar
Life Test	> 250000 cycles ( Meet The EN 200 Request )			
The Brusting Test	35 bar Water Static Pressure *No Deformation Found on the Cartridge.			

We perform 100 % High Air Pressure Testing on Each Cartridge Befor Dispatch

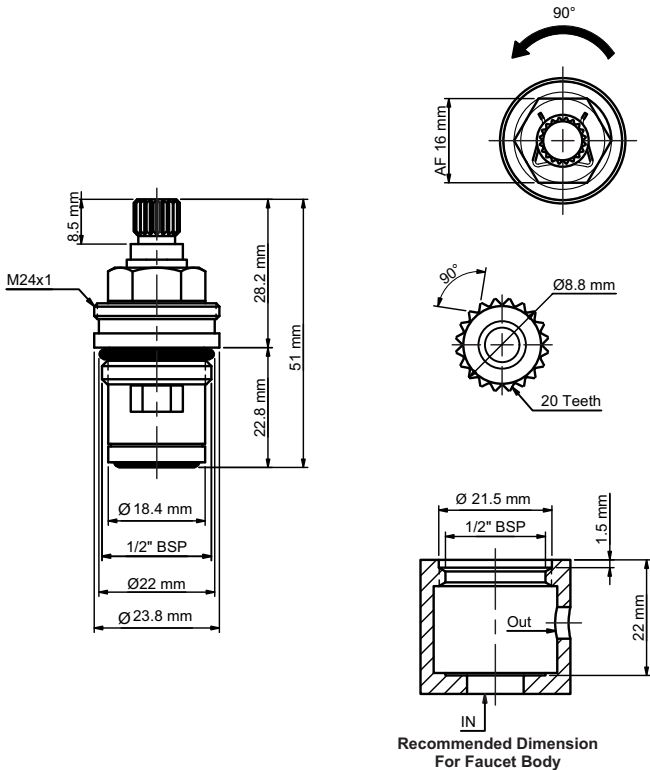

Technical Data	
Max. Rotation Angle	90°
Connection Thread	1/2" BSP - G 1/2"
Working Temperature	3-90° C
Fuction	QUICK OPEN FAUCET

Water Flow Rate Test								
Pressure (Bar)	0.5	1.0	1.5	2.0	2.5	3.0	3.5	4.0
Flow Rate (L/min)	7.9	11.7	14.7	17.2	19.5	21.4	23.3	24.8

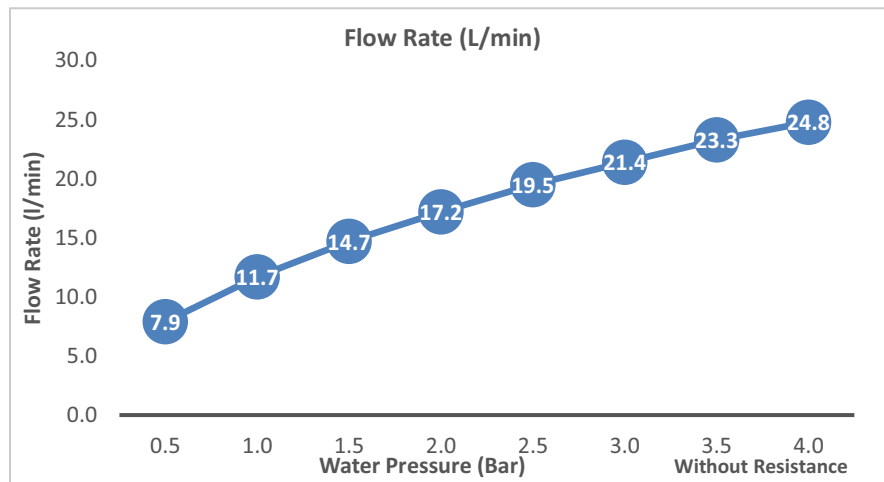

Technical Data Of The Ceramic Disc	
Material	97% AL <sub>2</sub> O <sub>3</sub>
Surface Roughness	Ra≤0.25µm
Flatness	≤0.6 µm
Surface Contact rate	50%-80%
Hardness	1050HV5

Material Specification	
Body Material	IS 319-I
Stem Material	IS 319-I
O'RING	NBR
Washer	Sillicon
Lubricating Ring	MOS-2
Lock	Copper

Sealing Test	Static Pressure	Air	High pressure	8 bar
		Water	Low pressure	0.2 bar
	Dynamic Pressure	Water	High pressure	25 bar
		Water	Low pressure	0.5 bar
Life Test	> 250000 cycles ( Meet The EN 200 Request )			
The Brusting Test	35 bar Water Static Pressure *No Deformation Found on the Cartridge.			

**We perform 100 % High Air Pressure Testing on Each Cartridge Befor Dispatch**

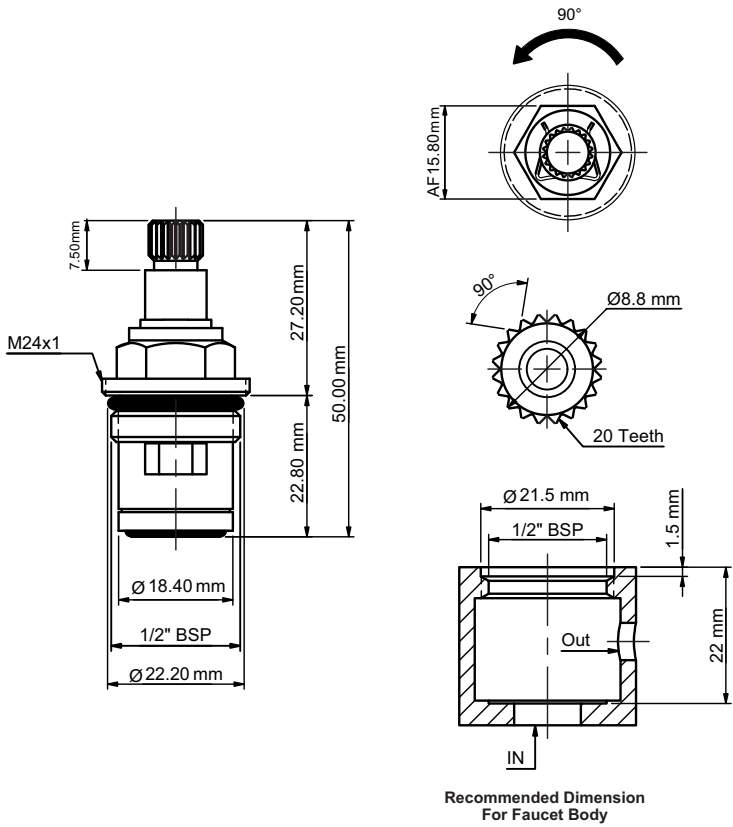

Recommended Dimension For Faucet Body

### Technical Data

Max. Rotation Angle	90°
Connection Thread	1/2" BSP - G 1/2"
Working Temperature	3-90° C
Fuction	QUICK OPEN FAUCET

### Water Flow Rate Test

Pressure (Bar)	0.5	1.0	1.5	2.0	2.5	3.0	3.5	4.0
Flow Rate (L/min)	7.9	11.7	14.7	17.2	19.5	21.4	23.3	24.8

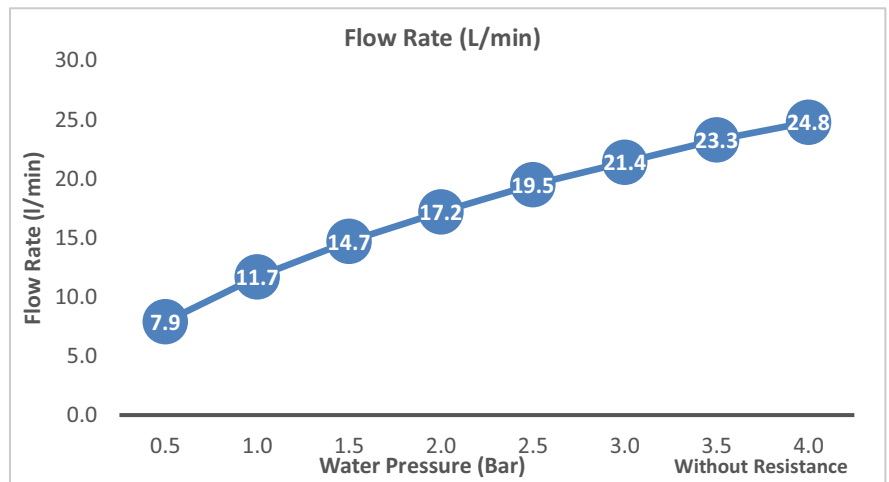

### Technical Data Of The Ceramic Disc

Material	97% AL <sub>2</sub> O <sub>3</sub>
Surface Roughness	Ra≤0.25µm
Flatness	≤0.6 µm
Surface Contact rate	50%-80%
Hardness	1050HV5

### Material Specification

Body Material	IS 319-I
Stem Material	IS 319-I
O'RING	NBR
Washer	Sillicon
Lubricating Ring	MOS-2
Lock	Copper

Sealing Test	Static Pressure	Air	High pressure	8 bar
		Water	Low pressure	0.2 bar
	Dynamic Pressure	Water	High pressure	25 bar
		Water	Low pressure	0.5 bar
Life Test	> 250000 cycles ( Meet The EN 200 Request )			
The Brusting Test	35 bar Water Static Pressure *No Deformation Found on the Cartridge.			

We perform 100 % High Air Pressure Testing on Each Cartridge Befor Dispatch



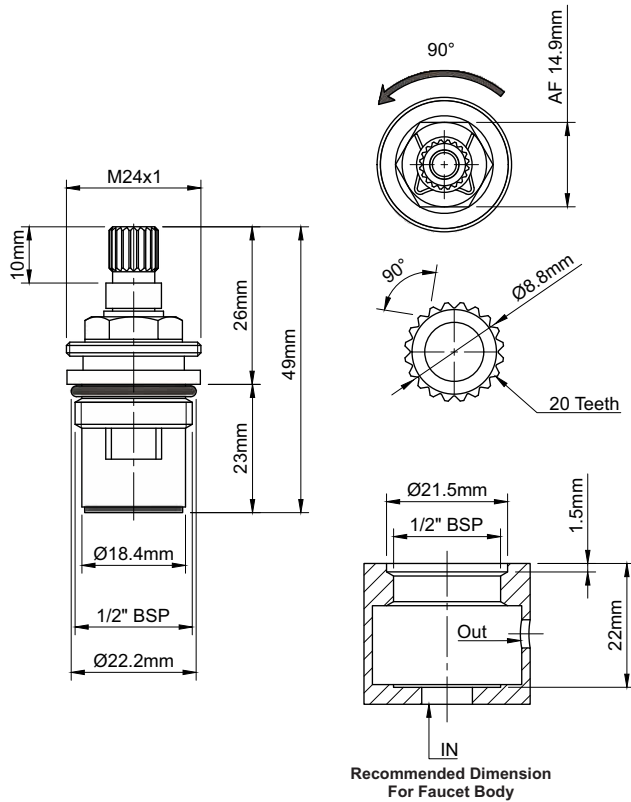

### Technical Data

Max. Rotation Angle	90°
Connection Thread	1/2" BSP - G 1/2"
Working Temperature	3-90° C
Fuction	QUICK OPEN FAUCET

### Water Flow Rate Test

Pressure (Bar)	0.5	1.0	1.5	2.0	2.5	3.0	3.5	4.0
Flow Rate (L/min)	7.9	11.7	14.7	17.2	19.5	21.4	23.3	24.8

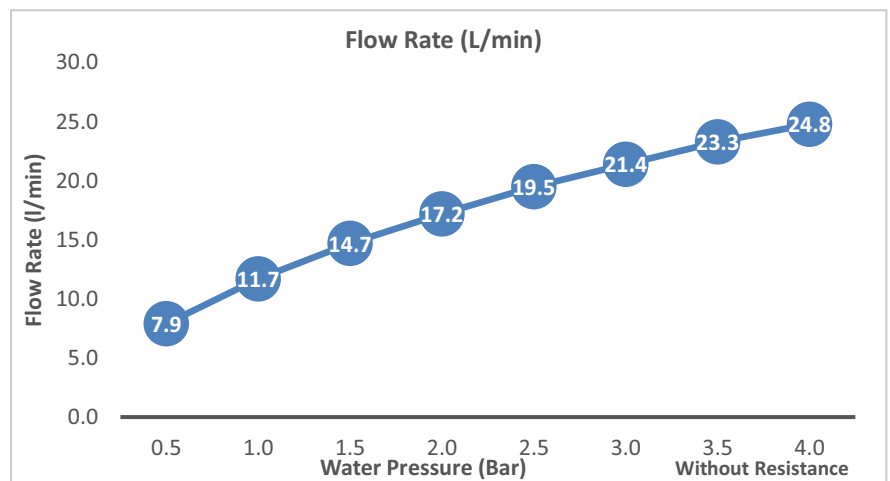

### Technical Data Of The Ceramic Disc

Material	97% AL <sub>2</sub> O <sub>3</sub>
Surface Roughness	Ra≤0.25μm
Flatness	≤0.6 μm
Surface Contact rate	50%-80%
Hardness	1050HV5

### Material Specification

Body Material	IS 319-I
Stem Material	IS 319-I
O'RING	NBR
Washer	Sillicon
Lubricating Ring	MOS-2
Lock	Copper

Sealing Test	Static Pressure	Air	High pressure	8 bar
		Water	Low pressure	0.2 bar
	Dynamic Pressure	Water	High pressure	25 bar
		Water	Low pressure	0.5 bar
Life Test	> 250000 cycles ( Meet The EN 200 Request )			
The Brusting Test	35 bar Water Static Pressure *No Deformation Found on the Cartridge.			

**We perform 100 % High Air Pressure Testing on Each Cartridge Befor Dispatch**

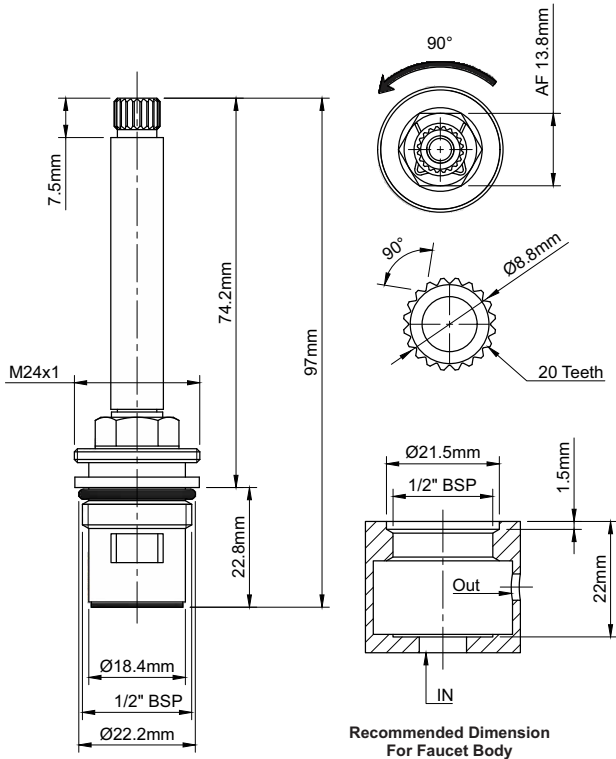

### Technical Data

Max. Rotation Angle	90°
Connection Thread	1/2" BSP - G 1/2"
Working Temperature	3-90° C
Fuction	QUICK OPEN FAUCET

### Water Flow Rate Test

Pressure (Bar)	0.5	1.0	1.5	2.0	2.5	3.0	3.5	4.0
Flow Rate (L/min)	7.9	11.7	14.7	17.2	19.5	21.4	23.3	24.8

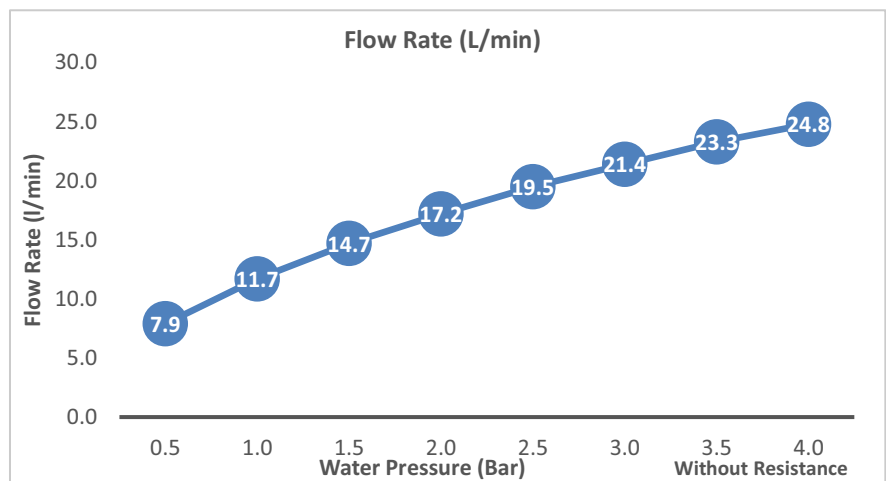

### Technical Data Of The Ceramic Disc

Material	97% AL <sub>2</sub> O <sub>3</sub>
Surface Roughness	Ra≤0.25µm
Flatness	≤0.6 µm
Surface Contact rate	50%-80%
Hardness	1050HV5

### Material Specification

Body Material	IS 319-I
Stem Material	IS 319-I
O'RING	NBR
Washer	Sillicon
Lubricating Ring	MOS-2
Lock	Copper

Sealing Test	Static Pressure	Air	High pressure	8 bar
		Water	Low pressure	0.2 bar
	Dynamic Pressure	Water	High pressure	25 bar
		Water	Low pressure	0.5 bar
Life Test	> 250000 cycles ( Meet The EN 200 Request )			
The Brusting Test	35 bar Water Static Pressure *No Deformation Found on the Cartridge.			

We perform 100 % High Air Pressure Testing on Each Cartridge Befor Dispatch

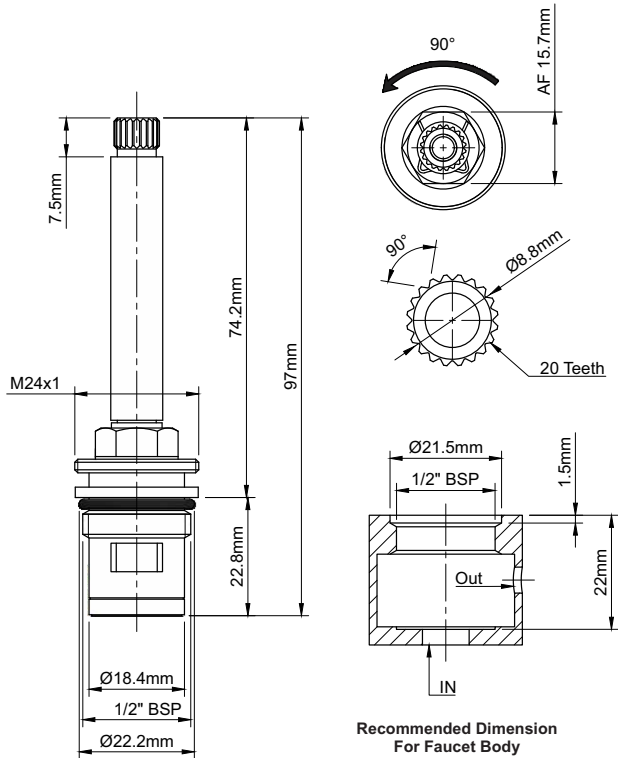

### Technical Data

Max. Rotation Angle	90°
Connection Thread	1/2" BSP - G 1/2"
Working Temperature	3-90° C
Fuction	QUICK OPEN FAUCET

### Water Flow Rate Test

Pressure (Bar)	0.5	1.0	1.5	2.0	2.5	3.0	3.5	4.0
Flow Rate (L/min)	7.9	11.7	14.7	17.2	19.5	21.4	23.3	24.8

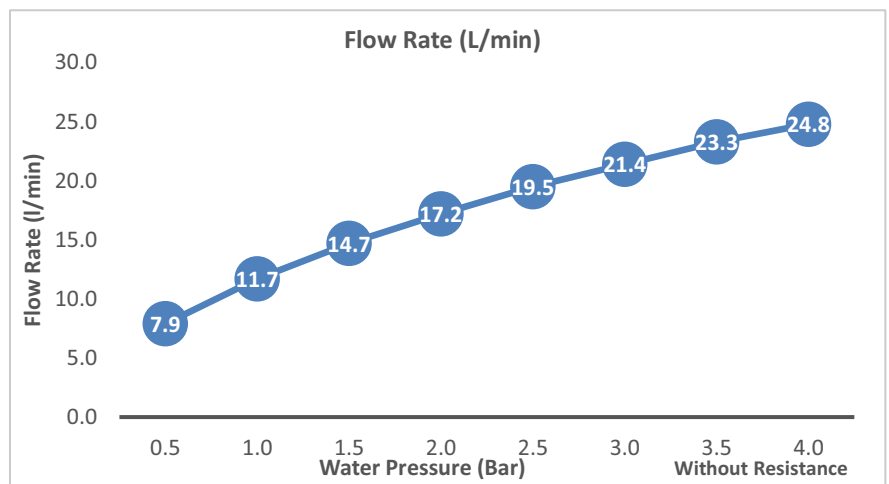

### Technical Data Of The Ceramic Disc

Material	97% AL <sub>2</sub> O <sub>3</sub>
Surface Roughness	Ra≤0.25µm
Flatness	≤0.6 µm
Surface Contact rate	50%-80%
Hardness	1050HV5

### Material Specification

Body Material	IS 319-I
Stem Material	IS 319-I
O'RING	NBR
Washer	Sillicon
Lubricating Ring	MOS-2
Lock	Copper

Sealing Test	Static Pressure	Air	High pressure	8 bar
		Water	Low pressure	0.2 bar
	Dynamic Pressure	Water	High pressure	25 bar
		Water	Low pressure	0.5 bar
Life Test	> 250000 cycles ( Meet The EN 200 Request )			
The Brusting Test	35 bar Water Static Pressure *No Deformation Found on the Cartridge.			

**We perform 100 % High Air Pressure Testing on Each Cartridge Befor Dispatch**



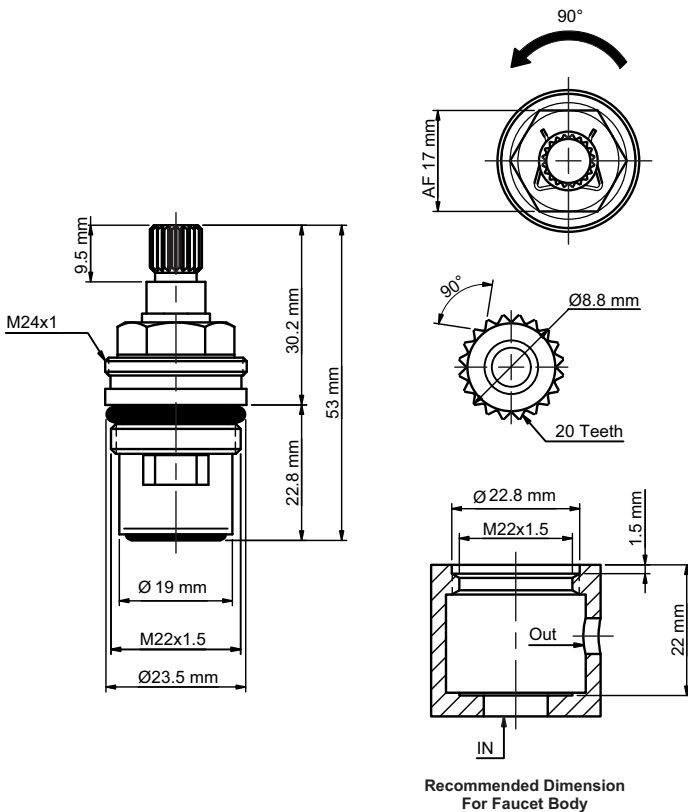

### Technical Data

Max. Rotation Angle	90°
Connection Thread	M22 X 1.5
Working Temperature	3-90° C
Fuction	QUICK OPEN FAUCET

### Water Flow Rate Test

Pressure (Bar)	0.5	1.0	1.5	2.0	2.5	3.0	3.5	4.0
Flow Rate (L/min)	8.1	12.0	15.1	17.5	19.9	21.5	22.9	24.0

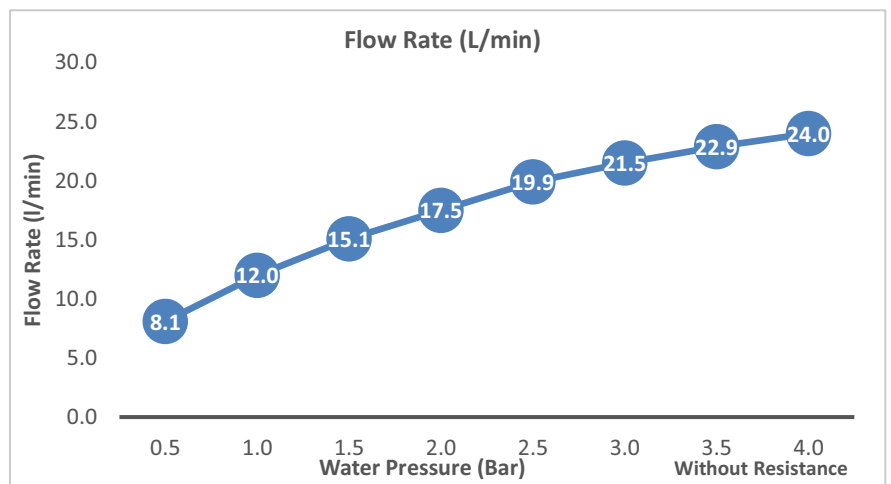

### Technical Data Of The Ceramic Disc

Material	97% AL <sub>2</sub> O <sub>3</sub>
Surface Roughness	Ra≤0.25µm
Flatness	≤0.6 µm
Surface Contact rate	50%-80%
Hardness	1050HV5

### Material Specification

Body Material	IS 319-I
Stem Material	IS 319-I
O'RING	NBR
Washer	Sillicon
Lubricating Ring	MOS-2
Lock	Copper

Sealing Test	Static Pressure	Air	High pressure	8 bar
		Water	Low pressure	0.2 bar
	Dynamic Pressure		High pressure	25 bar
		Low pressure	0.5 bar	
Life Test	> 250000 cycles ( Meet The EN 200 Request )			
The Brusting Test	35 bar Water Static Pressure *No Deformation Found on the Cartridge.			

**We perform 100 % High Air Pressure Testing on Each Cartridge Befor Dispatch**

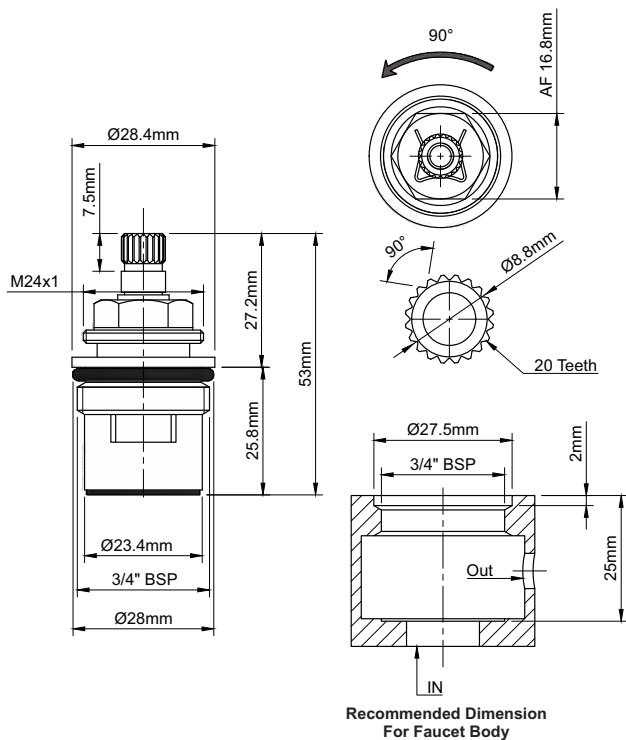

### Technical Data

Max. Rotation Angle	90°
Connection Thread	3/4" BSP - G 3/4"
Working Temperature	3-90° C
Fuction	QUICK OPEN FAUCET

### Water Flow Rate Test

Pressure (Bar)	0.5	1.0	1.5	2.0	2.5	3.0	3.5	4.0
Flow Rate (L/min)	9.5	13.4	16.4	19	21.4	23.3	25.4	27.1

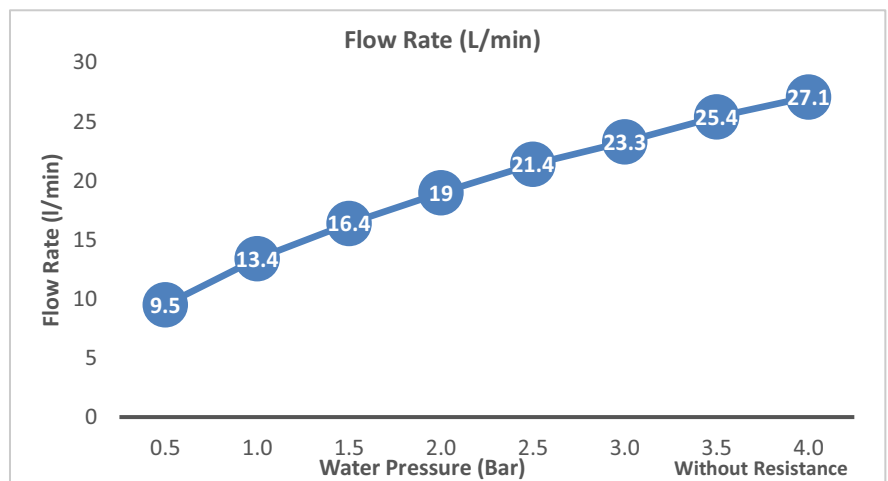

### Technical Data Of The Ceramic Disc

Material	97% AL <sub>2</sub> O <sub>3</sub>
Surface Roughness	Ra≤0.25μm
Flatness	≤0.6 μm
Surface Contact rate	50%-80%
Hardness	1050HV5

### Material Specification

Body Material	IS 319-I
Stem Material	IS 319-I
O'RING	NBR
Washer	Sillicon
Lubricating Ring	MOS-2
Lock	Copper

Sealing Test	Static Pressure	Air	High pressure	8 bar
		Water	Low pressure	0.2 bar
	Dynamic Pressure	Water	High pressure	25 bar
		Water	Low pressure	0.5 bar
Life Test	> 250000 cycles ( Meet The EN 200 Request )			
The Brusting Test	35 bar Water Static Pressure *No Deformation Found on the Cartridge.			

**We perform 100 % High Air Pressure Testing on Each Cartridge Befor Dispatch**

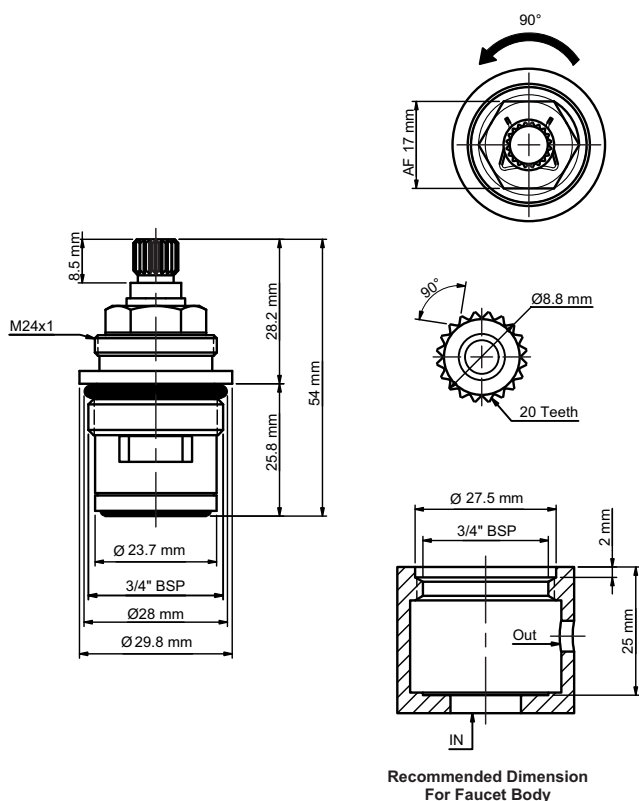

### Technical Data

Max. Rotation Angle	90°
Connection Thread	3/4" BSP - G 3/4"
Working Temperature	3-90° C
Fuction	QUICK OPEN FAUCET

### Water Flow Rate Test

Pressure (Bar)	0.5	1.0	1.5	2.0	2.5	3.0	3.5	4.0
Flow Rate (L/min)	9.5	13.4	16.4	19	21.4	23.3	25.4	27.1

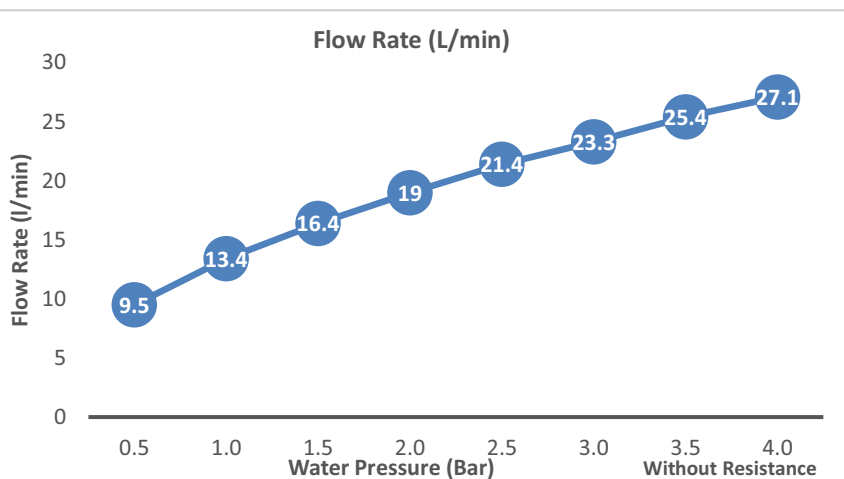

### Technical Data Of The Ceramic Disc

Material	97% AL <sub>2</sub> O <sub>3</sub>
Surface Roughness	Ra≤0.25µm
Flatness	≤0.6 µm
Surface Contact rate	50%-80%
Hardness	1050HV5

### Material Specification

Body Material	IS 319-I
Stem Material	IS 319-I
O'RING	NBR
Washer	Sillicon
Lubricating Ring	MOS-2
Lock	Copper

Sealing Test	Static Pressure	Air	High pressure	8 bar
		Water	Low pressure	0.2 bar
	Dynamic Pressure	Water	High pressure	25 bar
		Water	Low pressure	0.5 bar
Life Test	> 250000 cycles ( Meet The EN 200 Request )			
The Brusting Test	35 bar Water Static Pressure *No Deformation Found on the Cartridge.			

We perform 100 % High Air Pressure Testing on Each Cartridge Befor Dispatch



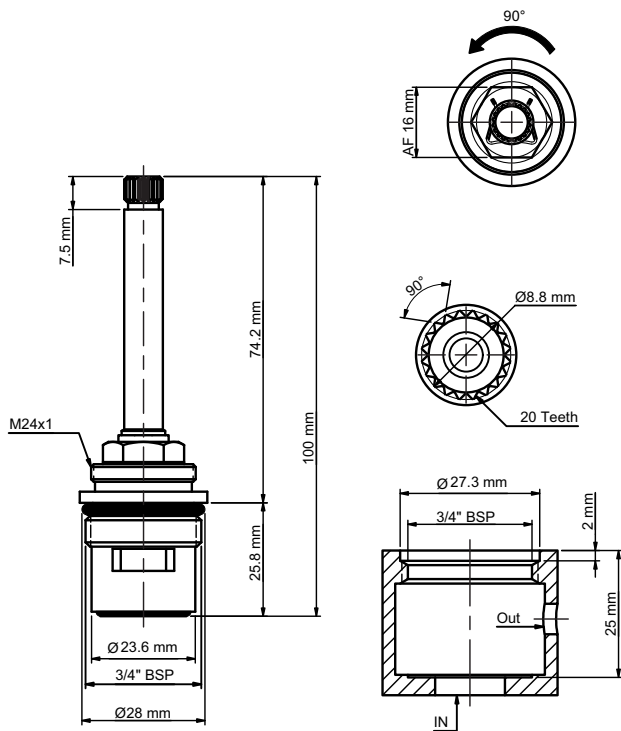

Recommended Dimension For Faucet Body



### Technical Data

Max. Rotation Angle	90°
Connection Thread	3/4" BSP - G 3/4"
Working Temperature	3-90° C
Fuction	QUICK OPEN FAUCET

### Water Flow Rate Test

Pressure (Bar)	0.5	1.0	1.5	2.0	2.5	3.0	3.5	4.0
Flow Rate (L/min)	9.5	13.4	16.4	19	21.4	23.3	25.4	27.1

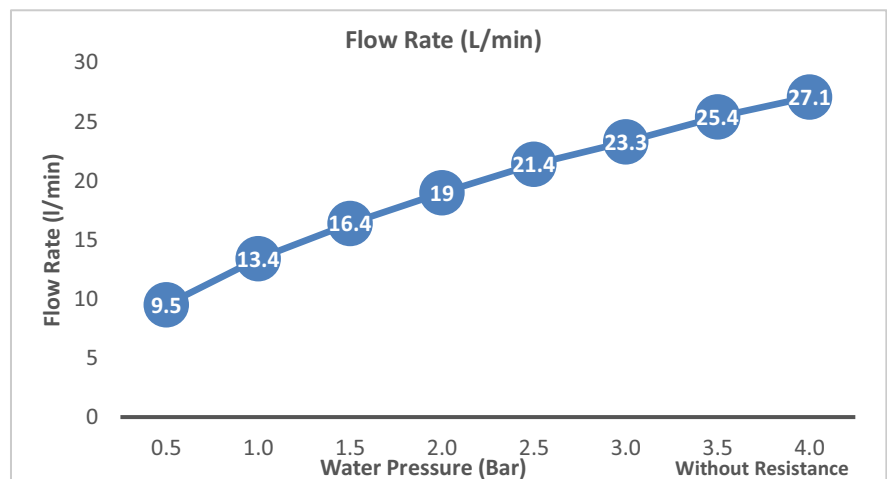

### Technical Data Of The Ceramic Disc

Material	97% AL <sub>2</sub> O <sub>3</sub>
Surface Roughness	Ra≤0.25µm
Flatness	≤0.6 µm
Surface Contact rate	50%-80%
Hardness	1050HV5

### Material Specification

Body Material	IS 319-I
Stem Material	IS 319-I
O'RING	NBR
Washer	Silicon
Lubricating Ring	MOS-2
Lock	Copper

Sealing Test	Static Pressure	Air	High pressure	8 bar
		Water	Low pressure	0.2 bar
	Dynamic Pressure	Water	High pressure	25 bar
		Water	Low pressure	0.5 bar
Life Test	> 250000 cycles ( Meet The EN 200 Request )			
The Brusting Test	35 bar Water Static Pressure *No Deformation Found on the Cartridge.			

We perform 100 % High Air Pressure Testing on Each Cartridge Befor Dispatch

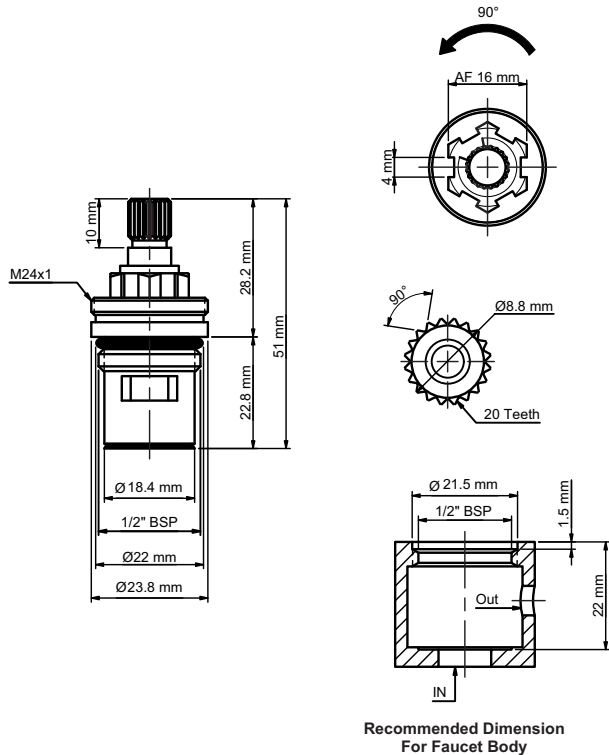

### Technical Data

Max. Rotation Angle	90°
Connection Thread	1/2" BSP - G 1/2"
Working Temperature	3-90° C
Fuction	QUICK OPEN FAUCET

### Water Flow Rate Test

Pressure (Bar)	0.5	1.0	1.5	2.0	2.5	3.0	3.5	4.0
Flow Rate (L/min)	7.6	11.2	14.3	16.8	18.8	20.8	22.3	23.9

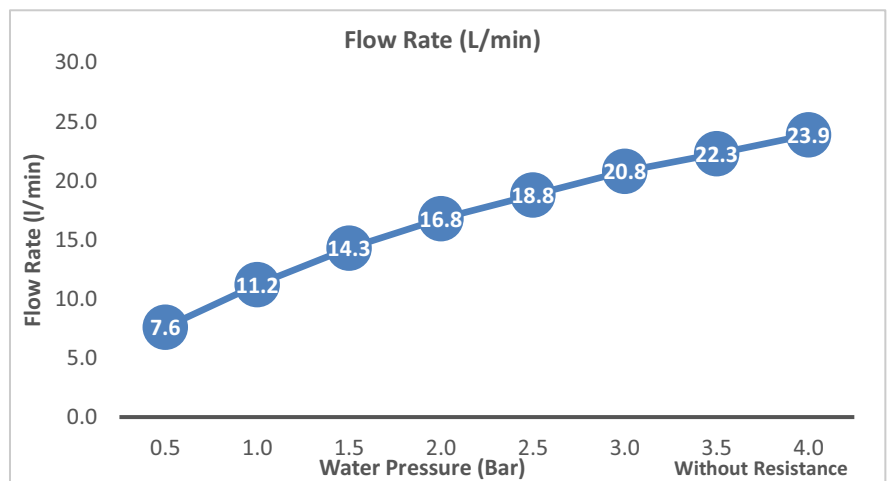

### Technical Data Of The Ceramic Disc

Material	97% AL <sub>2</sub> O <sub>3</sub>
Surface Roughness	Ra≤0.25µm
Flatness	≤0.6 µm
Surface Contact rate	50%-80%
Hardness	1050HV5

### Material Specification

Body Material	PA66
Stem Material	IS 319-I
O'RING	NBR
Washer	Sillicon
Lubricating Ring	MOS-2
Lock	POM

Sealing Test	Static Pressure	Air	High pressure	8 bar
		Water	Low pressure	0.2 bar
	Dynamic Pressure	Water	High pressure	25 bar
		Water	Low pressure	0.5 bar
Life Test	> 150000 cycles ( Meet The EN 200 Request )			
The Brusting Test	35 bar Water Static Pressure *No Deformation Found on the Cartridge.			

**We perform 100 % High Air Pressure Testing on Each Cartridge Befor Dispatch**

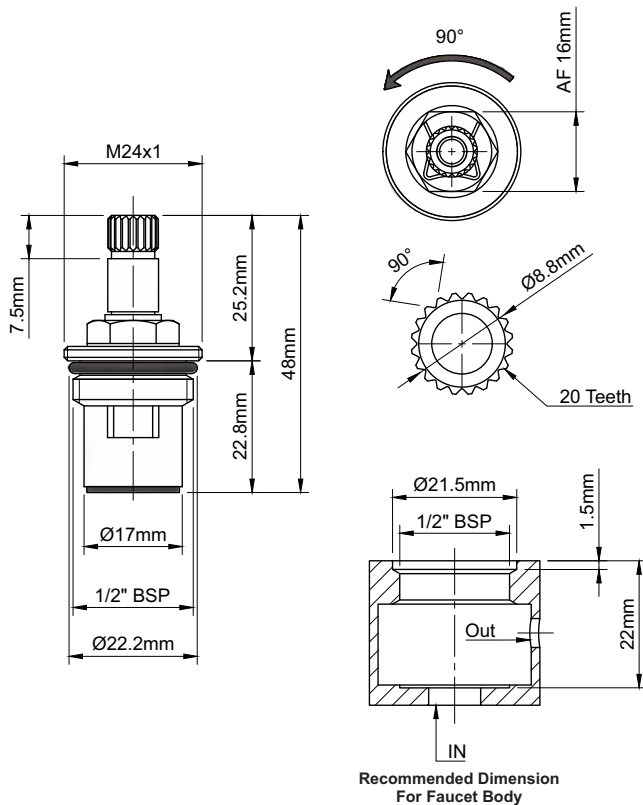

### Technical Data

Max. Rotation Angle	90°
Connection Thread	1/2" BSP - G 1/2"
Working Temperature	3-90° C
Fuction	QUICK OPEN FAUCET

### Water Flow Rate Test

Pressure (Bar)	0.5	1.0	1.5	2.0	2.5	3.0	3.5	4.0
Flow Rate (L/min)	7.0	8.8	11.0	12.2	14.0	16.0	17.1	18.2

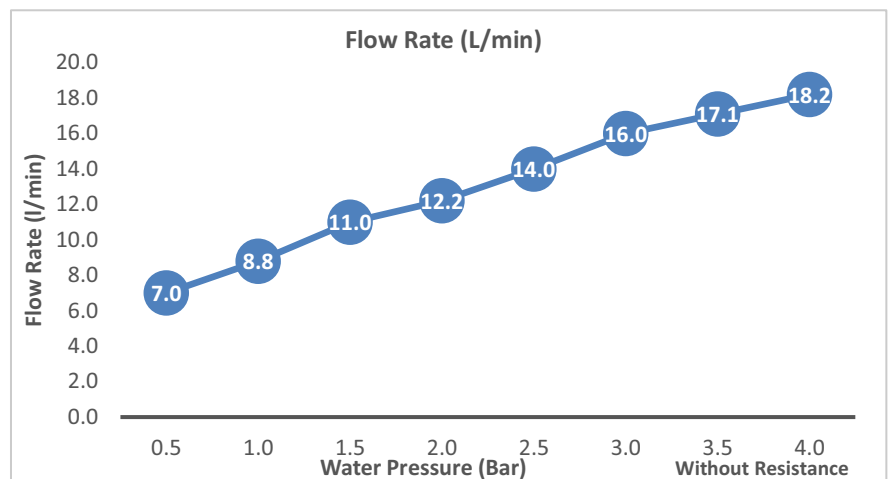

### Technical Data Of The Ceramic Disc

Material	97% AL <sub>2</sub> O <sub>3</sub>
Surface Roughness	Ra≤0.25µm
Flatness	≤0.6 µm
Surface Contact rate	50%-80%
Hardness	1050HV5

### Material Specification

Body Material	PA66
Stem Material	IS 319-I
O'RING	NBR
Washer	Sillicon
Lubricating Ring	MOS-2
Lock	POM

Sealing Test	Static Pressure	Air	High pressure	8 bar
		Water	Low pressure	0.2 bar
	Dynamic Pressure	Water	High pressure	25 bar
		Water	Low pressure	0.5 bar
Life Test	> 150000 cycles ( Meet The EN 200 Request )			
The Brusting Test	35 bar Water Static Pressure *No Deformation Found on the Cartridge.			

We perform 100 % High Air Pressure Testing on Each Cartridge Befor Dispatch

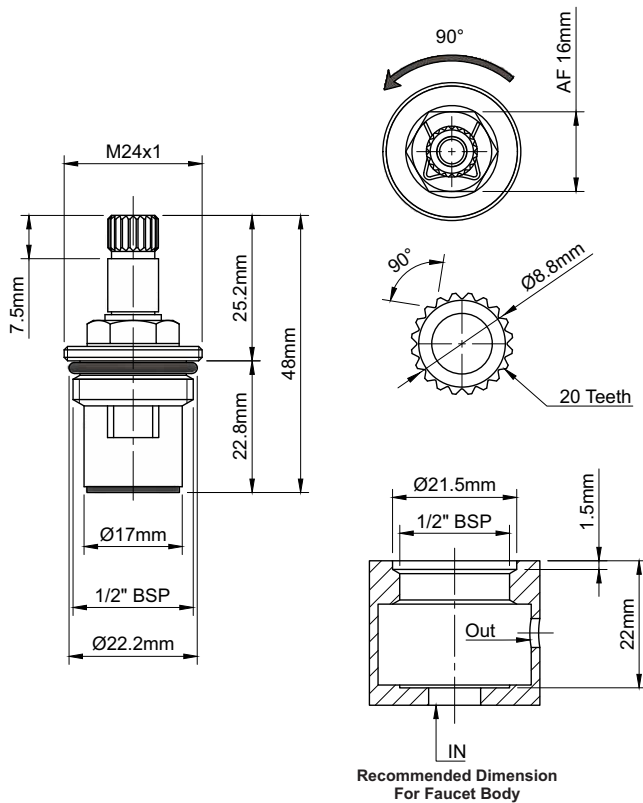

### Technical Data

Max. Rotation Angle	90°
Connection Thread	1/2" BSP - G 1/2"
Working Temperature	3-90° C
Fuction	QUICK OPEN FAUCET

### Water Flow Rate Test

Pressure (Bar)	0.5	1.0	1.5	2.0	2.5	3.0	3.5	4.0
Flow Rate (L/min)	7.0	8.8	11.0	12.2	14.0	16.0	17.1	18.2

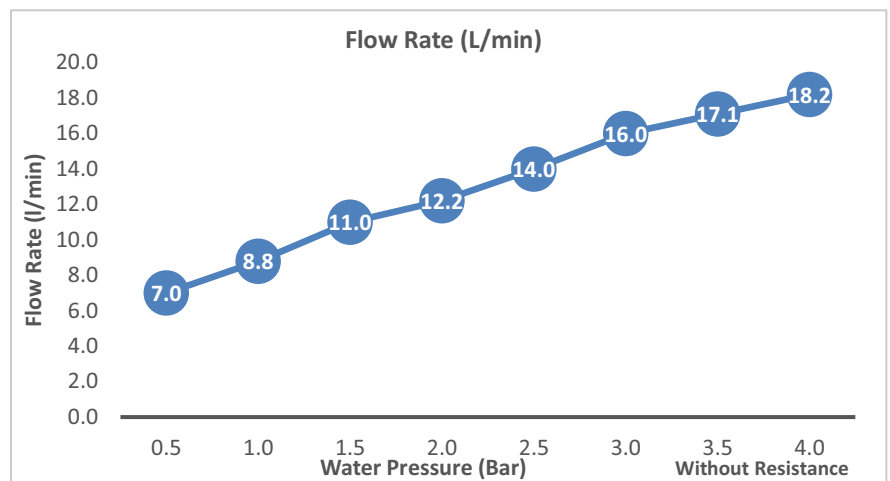

### Technical Data Of The Ceramic Disc

Material	97% AL <sub>2</sub> O <sub>3</sub>
Surface Roughness	Ra≤0.25µm
Flatness	≤0.6 µm
Surface Contact rate	50%-80%
Hardness	1050HV5

### Material Specification

Body Material	PA66
Stem Material	PA66
O'RING	NBR
Washer	Sillicon
Lubricating Ring	MOS-2
Lock	POM

Sealing Test	Static Pressure	Air	High pressure	8 bar
		Water	Low pressure	0.2 bar
	Dynamic Pressure	Water	High pressure	25 bar
		Air	Low pressure	0.5 bar
Life Test	> 150000 cycles ( Meet The EN 200 Request )			
The Brusting Test	35 bar Water Static Pressure *No Deformation Found on the Cartridge.			

**We perform 100 % High Air Pressure Testing on Each Cartridge Befor Dispatch**

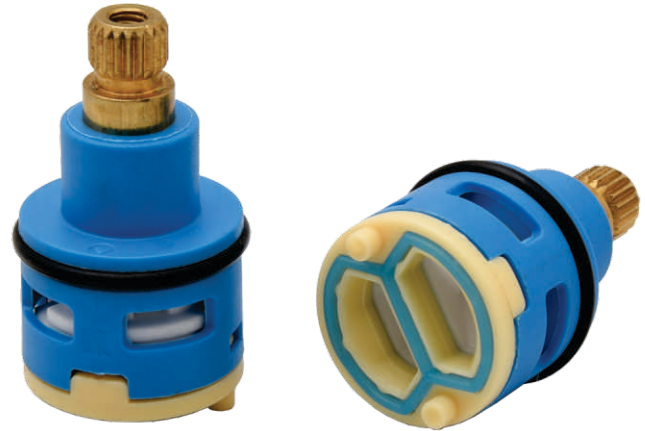
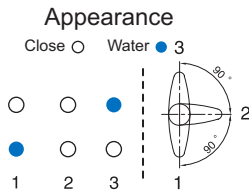
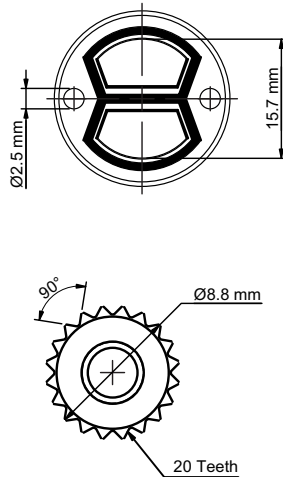
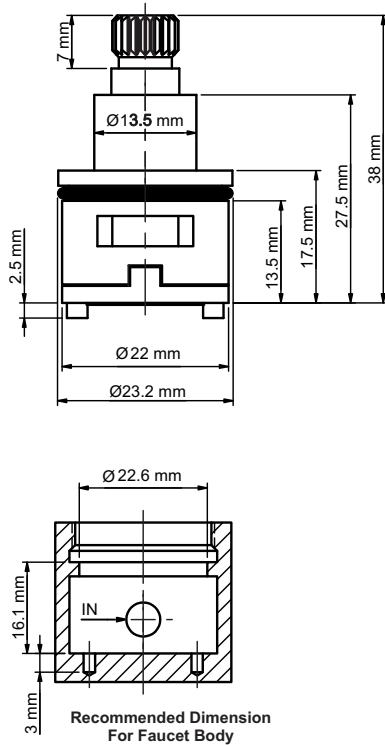

### Technical Data

Max. Rotation Angle	0-180°
Positions O-C-O	0°-90°-180°
Working Temperature	3-90° C
Fuction	Diverter Type
Tightening Torque	6 to 8 N.m

### Water Flow Rate Test

Pressure (Bar)	0.5	1.0	1.5	2.0	2.5	3.0	3.5	4.0
Flow Rate (L/min)	7.5	10.0	12.7	14.5	16.0	18.3	19.5	21.0

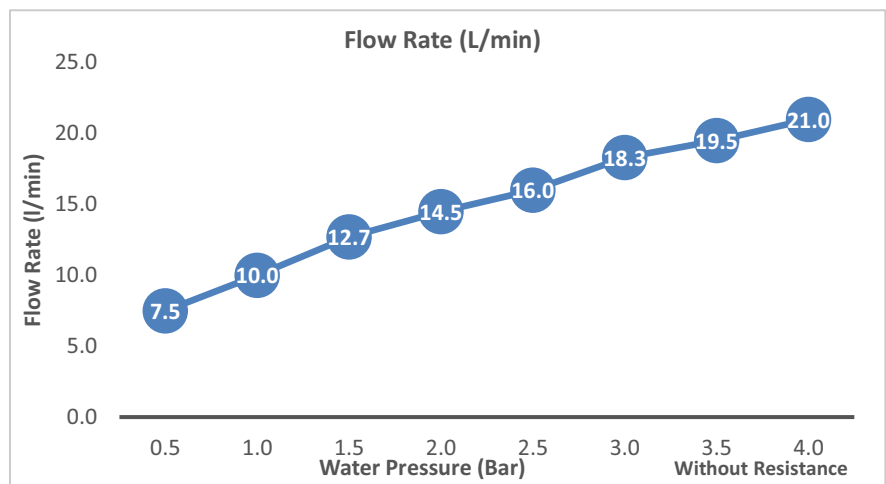

### Technical Data Of The Ceramic Disc

Material	99% AL <sub>2</sub> O <sub>3</sub>
Surface Roughness	Ra≤0.25μm
Flatness	≤0.6 μm
Surface Contact rate	50%-80%
Hardness	1050HV5

### Material Specification

Body Material	MPPO
Stem Material	IS 319-I
O'RING	NBR
Sealing Gasket	Sillicon
Lubricating Ring	POM
Holder	POM

Sealing Test	Static Pressure	Air	High pressure	8 bar
		Water	Low pressure	0.2 bar
	Dynamic Pressure		High pressure	25 bar
		Low pressure	0.5 bar	
Life Test	> 250000 cycles ( Meet The EN 817 Request )			
The Brusting Test	35 bar Water Static Pressure *No Deformation Found on the Cartridge.			

**We perform 100 % High Air Pressure Testing on Each Cartridge Befor Dispatch**



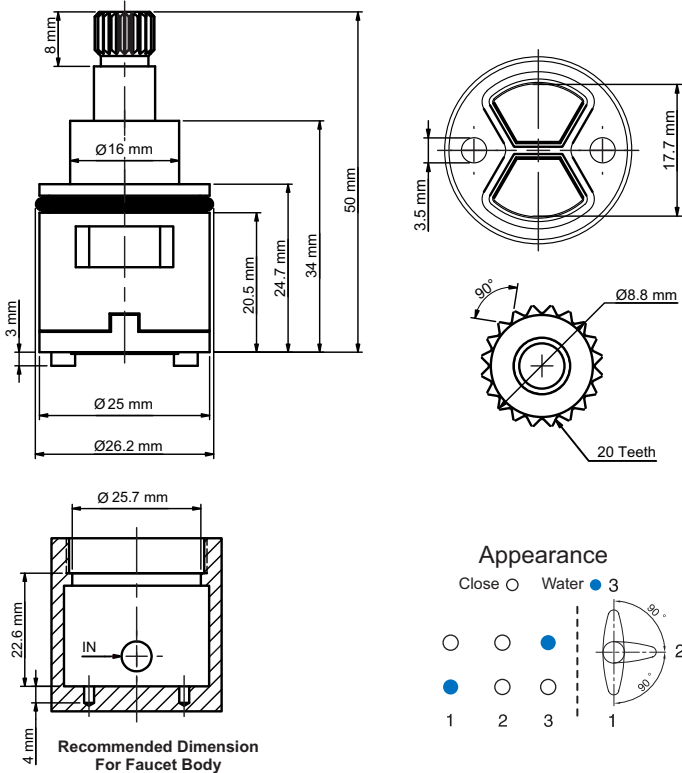

### Technical Data

Max. Rotation Angle	0-180°
Positions O-C-O	0°-90°-180°
Working Temperature	3-90° C
Fuction	Diverter Type
Tightening Torque	6 to 8 N.m

### Technical Data Of The Ceramic Disc

Material	99% AL <sub>2</sub> O <sub>3</sub>
Surface Roughness	Ra≤0.25μm
Flatness	≤0.6 μm
Surface Contact rate	50%-80%
Hardness	1050HV5

### Material Specification

Body Material	MPPO
Stem Material	IS 319-I
O'RING	NBR
Sealing Gasket	Sillicon
Lubricating Ring	POM
Holder	POM

### Water Flow Rate Test

Pressure (Bar)	0.5	1.0	1.5	2.0	2.5	3.0	3.5	4.0
Flow Rate (L/min)	9.5	12.6	15.1	16.9	19.5	21.6	23.9	25.4

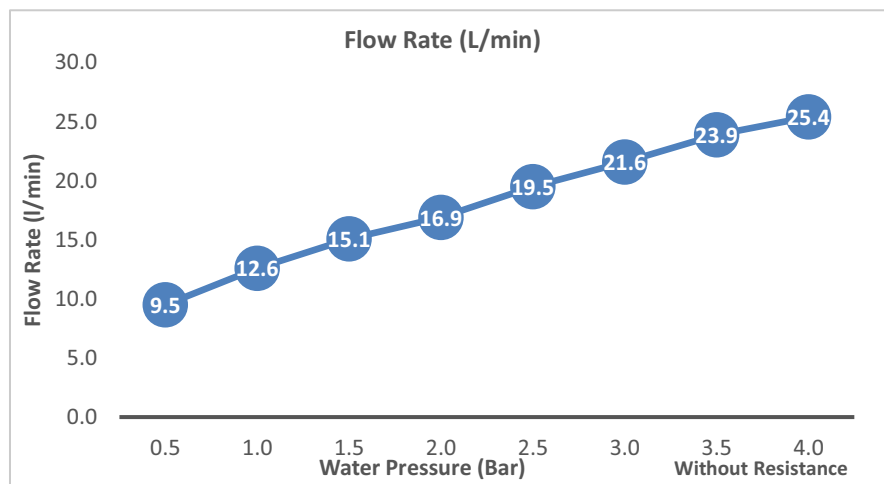

Sealing Test	Static Pressure	Air	High pressure	8 bar
		Water	Low pressure	0.2 bar
	Dynamic Pressure	Water	High pressure	25 bar
		Water	Low pressure	0.5 bar
Life Test	> 250000 cycles ( Meet The EN 817 Request )			
The Brusting Test	35 bar Water Static Pressure *No Deformation Found on the Cartridge.			

**We perform 100 % High Air Pressure Testing on Each Cartridge Befor Dispatch**

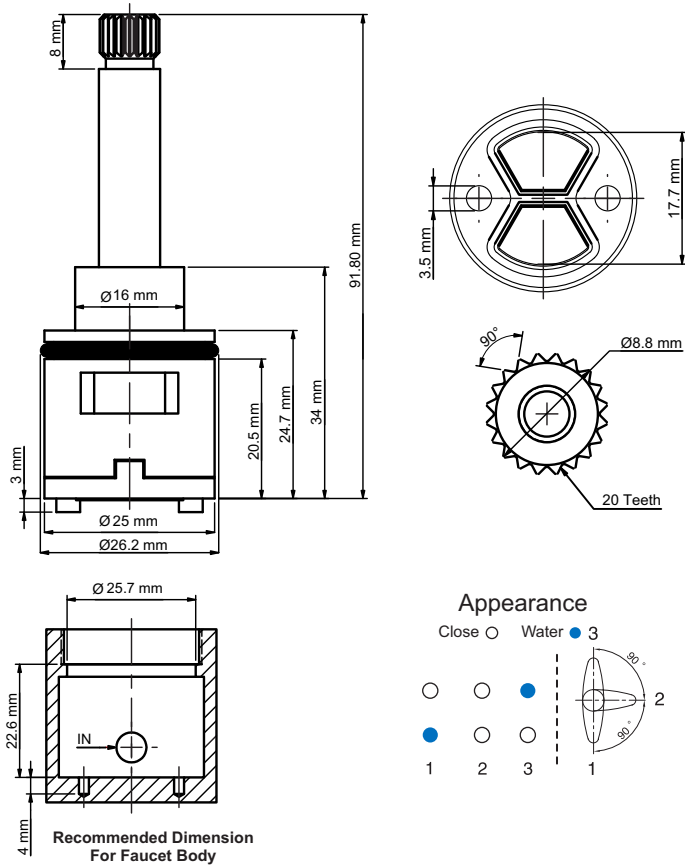

### Technical Data

Max. Rotation Angle	0-180°
Positions O-C-O	0°-90°-180°
Working Temperature	3-90° C
Fuction	Diverter Type
Tightening Torque	6 to 8 N.m

### Technical Data Of The Ceramic Disc

Material	99% AL <sub>2</sub> O <sub>3</sub>
Surface Roughness	Ra≤0.25μm
Flatness	≤0.6 μm
Surface Contact rate	50%-80%
Hardness	1050HV5

### Material Specification

Body Material	MPPO
Stem Material	IS 319-I
O'RING	NBR
Sealing Gasket	Sillicon
Lubricating Ring	POM
Holder	POM

### Water Flow Rate Test

Pressure (Bar)	0.5	1.0	1.5	2.0	2.5	3.0	3.5	4.0
Flow Rate (L/min)	9.5	12.6	15.1	16.9	19.5	21.6	23.9	25.4

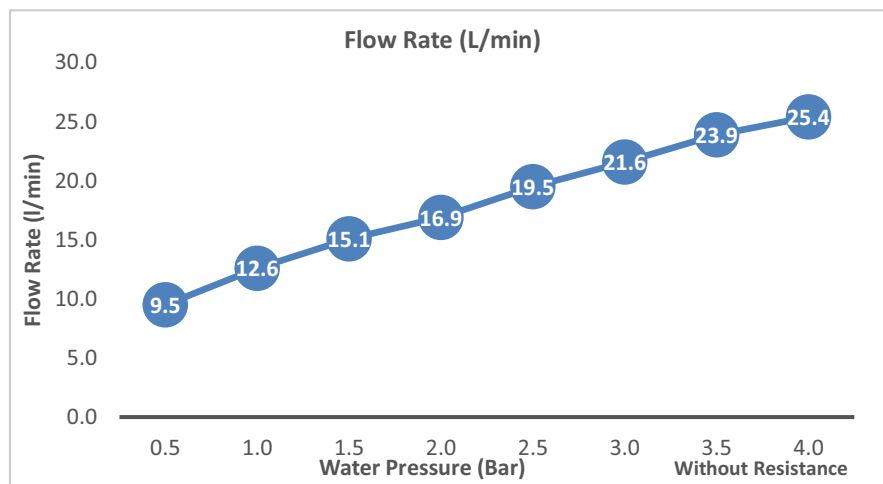

Sealing Test	Static Pressure	Air	High pressure	8 bar
		Water	Low pressure	0.2 bar
Dynamic Pressure	Water		High pressure	25 bar
	Water	Low pressure	0.5 bar	
Life Test	> 250000 cycles ( Meet The EN 817 Request )			
The Brusting Test	35 bar Water Static Pressure *No Deformation Found on the Cartridge.			

**We perform 100 % High Air Pressure Testing on Each Cartridge Befor Dispatch**

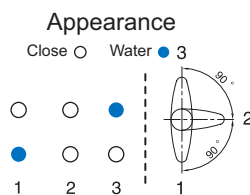
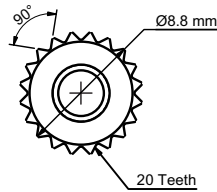
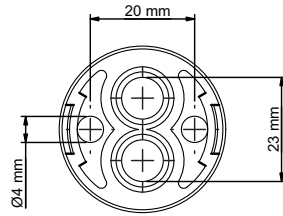
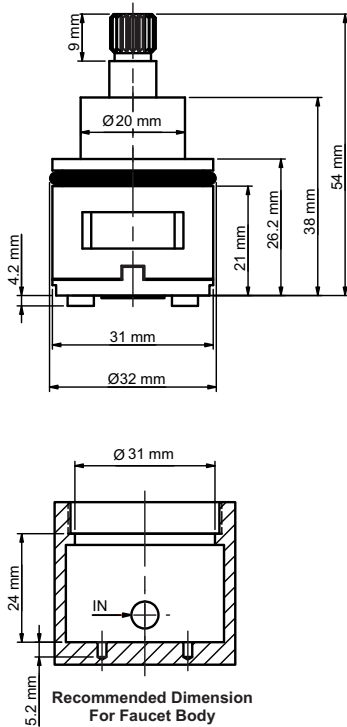

### Technical Data

Max. Rotation Angle	0-180°
Positions O-C-O	0°-90°-180°
Working Temperature	3-90° C
Fuction	Diverter Type
Tightening Torque	6 to 8 N.m

### Water Flow Rate Test

Pressure (Bar)	0.5	1.0	1.5	2.0	2.5	3.0	3.5	4.0
Flow Rate (L/min)	12.1	15.7	18.4	21.1	23.5	26.7	29.1	32.1

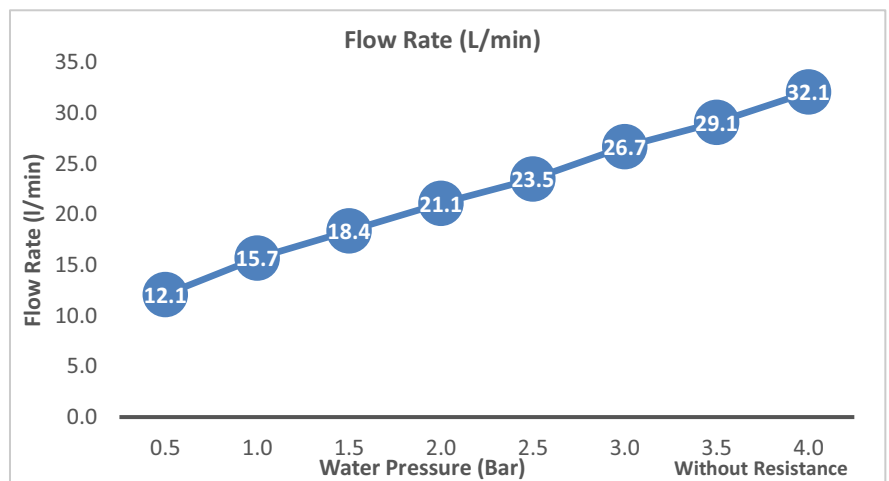

### Technical Data Of The Ceramic Disc

Material	99% AL <sub>2</sub> O <sub>3</sub>
Surface Roughness	Ra≤0.25μm
Flatness	≤0.6 μm
Surface Contact rate	50%-80%
Hardness	1050HV5

### Material Specification

Body Material	MPPO
Stem Material	IS 319-I
O'RING	NBR
Sealing Gasket	Silicon
Lubricating Ring	POM
Holder	POM

Sealing Test	Static Pressure	Air	High pressure	8 bar
		Water	Low pressure	0.2 bar
	Dynamic Pressure	Water	High pressure	25 bar
		Water	Low pressure	0.5 bar
Life Test	> 250000 cycles ( Meet The EN 817 Request )			
The Brusting Test	35 bar Water Static Pressure *No Deformation Found on the Cartridge.			

We perform 100 % High Air Pressure Testing on Each Cartridge Befor Dispatch



# Other Cartridge



35 MM CERAMIC CARTRIDGE



35 MM CERAMIC CARTRIDGE



40 MM HIGH FLOW  
CERAMIC CARTRIDGE



W/M PISTON SET



40 MM CERAMIC CARTRIDGE



W/M PISTON SET



45 MM HIGH FLOW  
CERAMIC CARTRIDGE



3/4 CONCEALED VALVE



# Engineering Plastic Parts



15.50 MM CERAMIC DISC HOLDER			
NO	THICKNESS	DEGREE	CODE
1	2.50 MM	90°	DH01
2	2.50 MM	45°	DH02
3	3.50 MM	90°	DH03
4	3.50 MM	45°	DH04
5	4.50 MM	45°	DH05

15.80 MM CERAMIC DISC HOLDER			
NO	THICKNESS	DEGREE	CODE
1	2.50 MM	90°	DH06
2	3.50 MM	90°	DH07
3	3.50 MM	45°	DH08

21 MM CERAMIC DISC HOLDER			
NO	THICKNESS	DEGREE	CODE
1	4.50 MM	90°	DH09
2	4.50 MM	45°	DH10



MOS-2 RING				
NO	O.D.	I.D.	T	CODE
1	14.80	12.70	1.00	SRM01
2	14.80	12.00	1.00	SRM02
3	16.50	14.00	1.00	SRM03



WASHER RING				
NO	O.D.	I.D.	T	CODE
1	12.00	10.00	1.00	WRP01
2	13.00	10.00	1.20	WRP02
3	13.50	10.00	1.50	WRP03
4	14.00	10.00	1.20	WRP04
5	14.00	10.00	1.50	WRP05
6	16.50	14.00	1.00	WRP06
7	19.00	15.50	1.20	WRP07
8	19.00	15.50	1.50	WRP08



COPPER LOCK 1/2 & 3/4



VALVE KNOB RING



VALVE KNOB RING



AERATOR



AERATOR NORMAL



VALVE HANDLE CAP



VALVE HANDLE CAP



VALVE KNOB



GAS REGULATOR KNOB



RECIPROCATOR



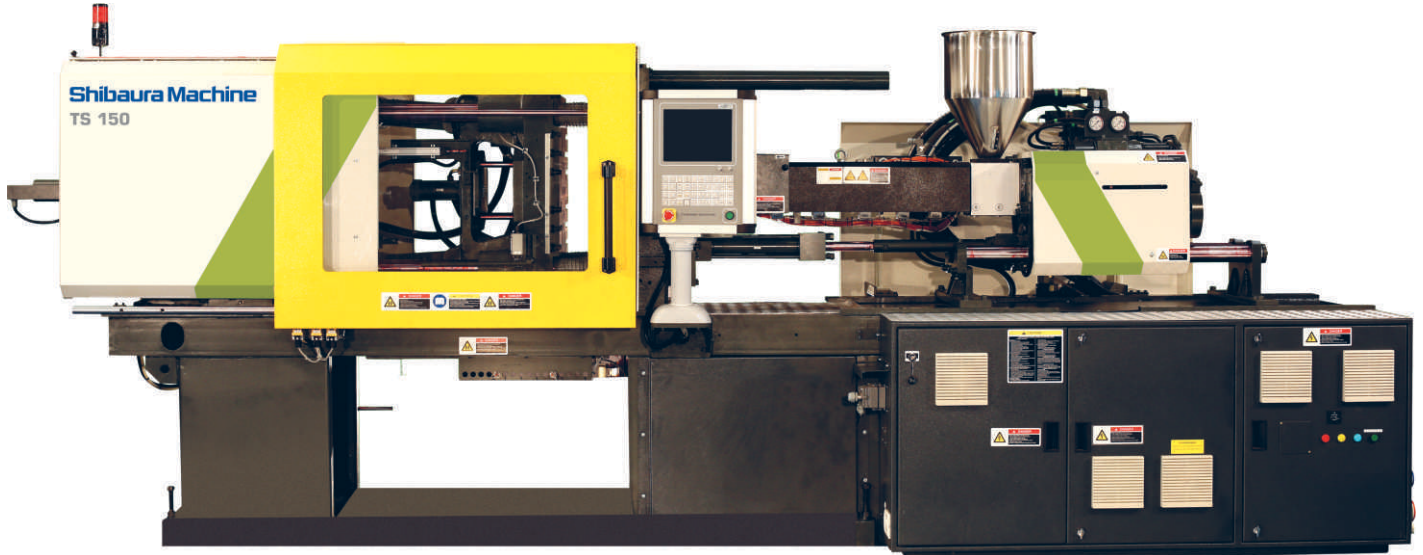

## Injection Moulding Machine



## Vertical Injection Moulding Machine



**CNC Machine**

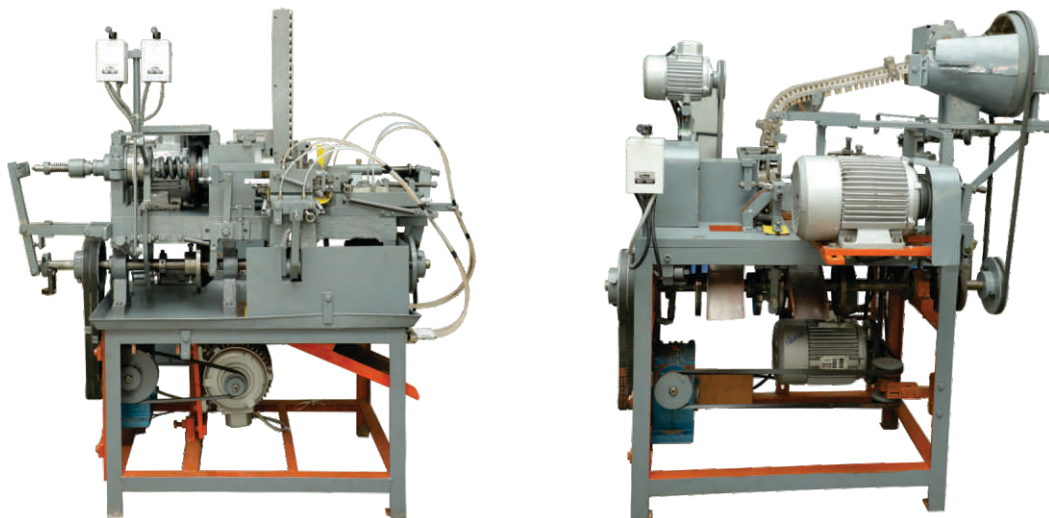

**SPM Machine**





**Leakage Testing Machine**



**Laser Marking Machine**



**Semi Finish Material Storage**







## Venus Precision

Mfg.: All kind of Brass Precision Parts, Sp. in Ceramic Spindle

Plot No. 723, Phase-II, G.I.D.C., Dared, Jamnagar-361 004.

Web : [www.venusprecision.com](http://www.venusprecision.com)

Email : [info@venusprecision.com](mailto:info@venusprecision.com)

Contact : +91 94294 23677